

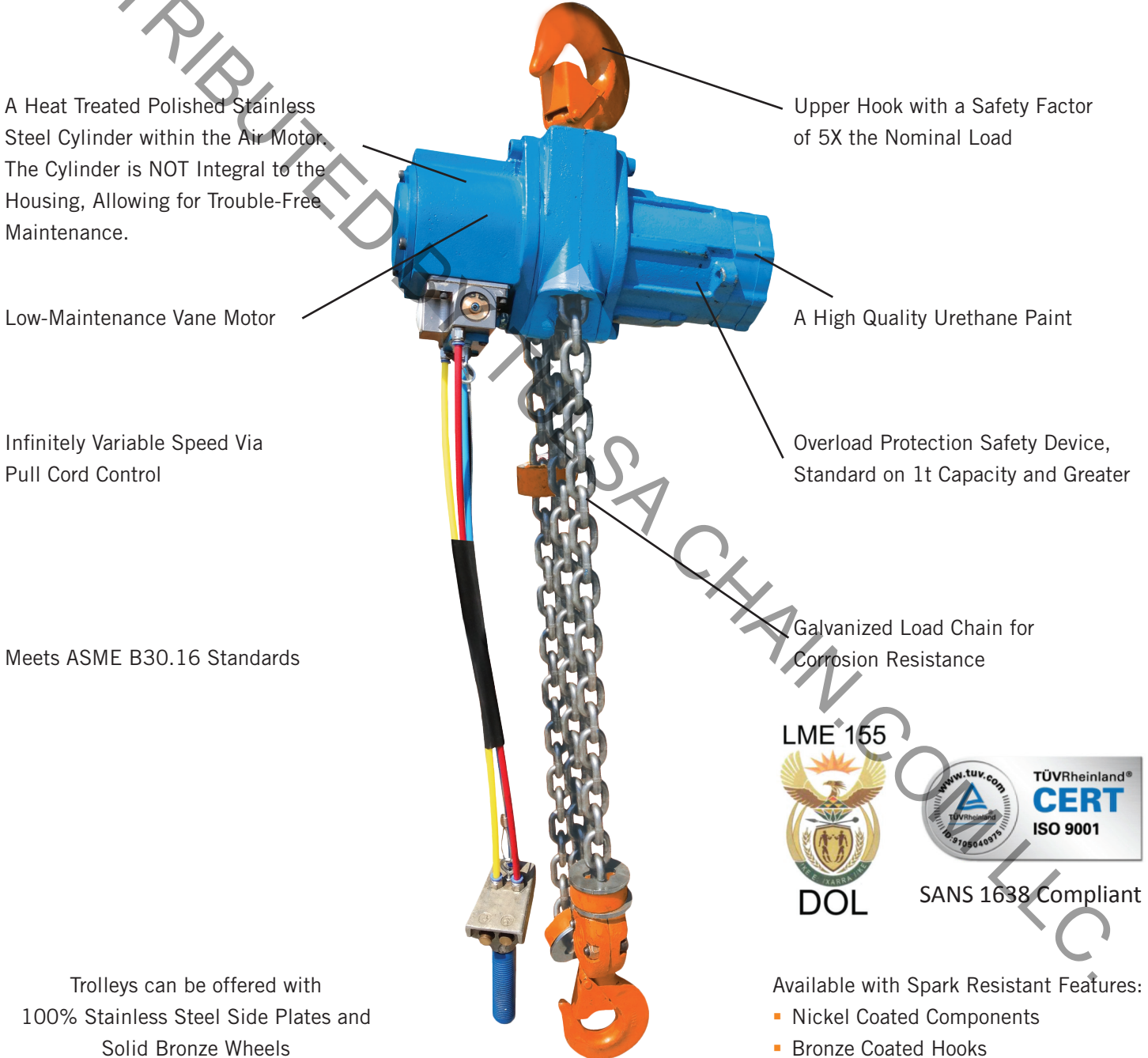

Standard Model ATS Air Chain Hoists are Acceptable for Division 1 & 2 Applications

- Division 1 (Spark-Resistant air hoists are required)
Atmospheres containing hazardous concentrations of flammable gases, dusts, or fibers, continuously, frequently or periodically, under normal operating conditions.
- Division 2 (Standard air hoists are required)
Atmospheres, normally non-hazardous, in which a hazardous concentration of flammable gases, dusts, or fibers, occurs when a container or handling system fails, or the ventilating system which normally keeps the concentration non-hazardous fails



A Heat Treated Polished Stainless Steel Cylinder within the Air Motor. The Cylinder is NOT Integral to the Housing, Allowing for Trouble-Free Maintenance.

Upper Hook with a Safety Factor of 5X the Nominal Load

Low-Maintenance Vane Motor

A High Quality Urethane Paint

Infinitely Variable Speed Via Pull Cord Control

Overload Protection Safety Device, Standard on 1t Capacity and Greater

Meets ASME B30.16 Standards

Galvanized Load Chain for Corrosion Resistance

LME 155



DOL



SANS 1638 Compliant

Trolleys can be offered with 100% Stainless Steel Side Plates and Solid Bronze Wheels

Available with Spark Resistant Features:

- Nickel Coated Components
- Bronze Coated Hooks
- Stainless Steel Components





ATS INDUSTRIAL SERIES AIR CHAIN HOIST 0.25ton-2ton

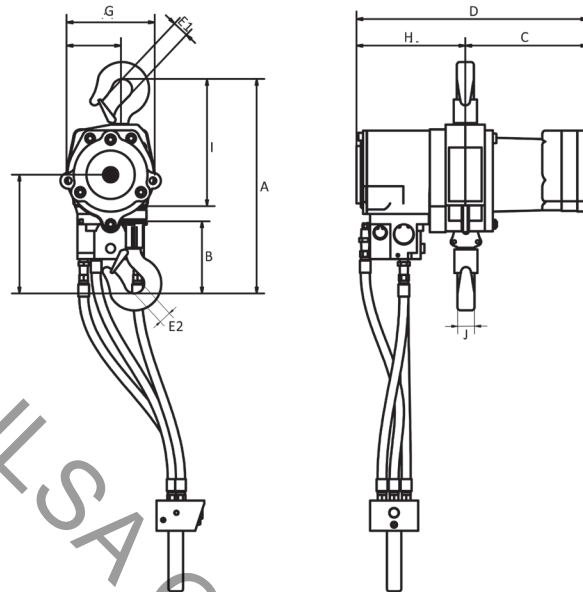
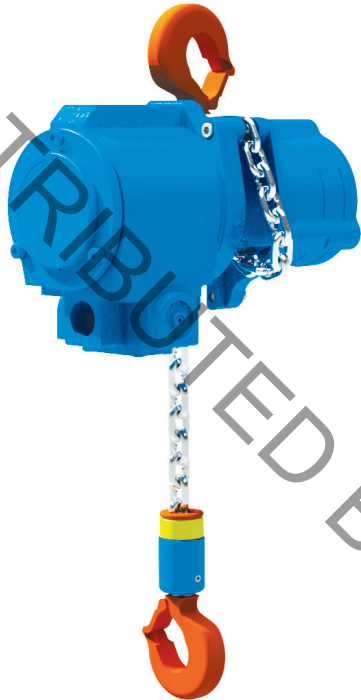

SPECIFICATIONS - ATS AIR CHAIN HOIST - 0.25ton - 2ton					
Property	Unit	0.25	0.5	1	2
Lifting Capacity	mt	0.25	0.5	1	2
	T	0.27	0.55	1.1	2.2
Number of Fall of Chain		1	1	1	1
Motor Power Output	H.P.	1.9	1.9	1.9	2.4
	kW	1.4	1.4	1.4	1.8
Weight with Pull Cord	lbs.	55	55	64	72
Weight with Pilot Pendant	lbs.	62	62	71	79
Chain Weight Per Additional Foot of Lift	lbs.	0.75	0.75	0.75	1.5
Chain Dimension	mm	7x21	7x21	7x21	9x27
Air Pressure	PSI	87	87	87	87
	bar	6	6	6	6
Air Consumption at Full Load	cfm	60-75	60-75	60-75	95
	m3/min	1.75	1.75	1.75	1.75
Air Hose Connection	1" BSP				
Air Hose Dimension	3/4" (19mm - 25mm)				
Lifting Speed at Full Load	ft. / min.	89	62	36	29
Lifting Speed without Load	ft. / min.	98	98	45	43
Lower Speed with Full Load	ft. / min.	108	108	36	45
Standard Lift	ft.	10	10	10	10
Length of Control for Standard Lift	ft.	6.5	6.5	6.5	6.5
Noise Level	84 DbA @ 1m				

DIMENSIONS - ATS AIR CHAIN HOIST - 0.25ton - 2 ton					
Type		0.25 ton	0.5 ton	1 ton	2 ton
A min. headroom	inch	12.8	12.8	12.8	12.8
	mm	325	325	325	325
B	inch	4.0	4.0	4.7	4.7
	mm	102	102	120	120
C	inch	3.9	3.9	8.0	8.0
	mm	99	99	202	202
D	inch	10.8	10.8	15.0	15.0
	mm	274	274	382	382
E1	inch	0.9	0.9	1.3	1.3
	mm	22	22	32	32
E2	inch	0.9	0.9	1.3	1.3
	mm	22	22	32	32
G maximum width	inch	5.7	5.7	5.7	5.7
	mm	146	146	146	146
H	inch	6.9	6.9	7.1	7.1
	mm	175	175	180	180
I	inch	7.7	7.7	8.3	8.3
	mm	196	196	211	211
J (hook Width)	inch	0.7	0.7	0.9	0.9
	mm	19	19	23	23

* Chain containers will increase headroom

ELEPHANT
LIFTING PRODUCTS™

CALL TOLL-FREE 888-844-6113



ATS INDUSTRIAL SERIES AIR CHAIN HOIST 3ton-10ton

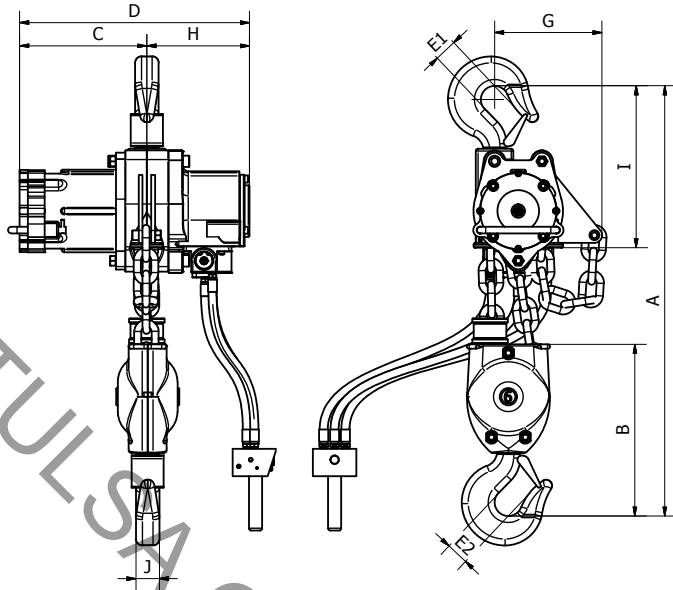

SPECIFICATIONS - ATS AIR CHAIN HOIST - 3ton - 10ton

	mt	3	4.2	5	6	10
Lifting Capacity	T	3.3	4.6	5.5	6.6	11
Number of Fall of Chain		1	1	1	2	2
Motor Power Output	H.P.	2.4	3.3	3.3	2.4	3.3
	kW	1.8	2.5	2.5	1.8	2.5
Weight with Pull Cord	lbs.	130	160	162	171	267
Weight with Pilot Pendant	lbs.	137	167	169	178	274
Chain Weight Per Additional Foot of Lift	lbs.	2.6	2.5	3	5.2	7.9
Chain Dimension	mm	13 x 36	13 x 36	16 x 45	13 x 36	16 x 45
Air Pressure	PSI	72-102	72-102	72-102	72-102	72-102
	bar	5-7	5-7	5-7	5-7	5-7
Air Consumption at Full Load	cfm	110	110	110	110	110
	m3/min	1.75	1.75	1.75	1.75	1.75
Air Hose Connection	1" BSP					
Air Hose Dimension	3/4" (19mm - 25mm)					
Lifting Speed at Full Load	ft. / min.	18.3	8.5	8.5	9.3	4.2
Lifting Speed without Load	ft. / min.	23.75	9.8	18.3	13.1	9.1
Lower Speed with Full Load	ft. / min.	25.4	11.4	2.4	14.3	11.8
Standard Lift	ft.	10	10	10	10	10
Length of Control for Standard Lift	ft.	6.5	6.5	6.5	6.5	6.5
Noise Level	84 DbA @ 1m					

DIMENSIONS - ATS AIR CHAIN HOIST - 3ton - 10ton

Type		3 ton	4.2 ton	5 ton	6 ton	10 ton
A min. headroom	inch	20.6	22.6	24.5	25.6	31.5
	mm	522	575	623	650	800
B	inch	8.9	10.8	10.8	13.1	12.6
	mm	225	275	275	333	320
C	inch	9.2	10.5	10.7	9.2	10.5
	mm	234	266	271	234	267
D	inch	18.9	17.9	18.3	18.9	20.5
	mm	480	454	464	480	521
E1	inch	1.6	1.7	1.7	1.6	1.7
	mm	40	42	42	40	42
E2	inch	1.6	1.7	1.7	1.6	1.7
	mm	40	42	42	40	42
G maximum width	inch	9.4	7.8	11.2	9.4	13.4
	mm	240	198	285	240	340
H	inch	9.7	7.4	7.6	9.7	10.0
	mm	246	188	193	246	254
I	inch	11.8	11.7	13.8	16.7	18.9
	mm	299	297	351	423	480
J (hook Width)	inch	1.8	3.1	3.1	1.9	2.1
	mm	45	80	80	48	53

* Chain containers will increase headroom

