

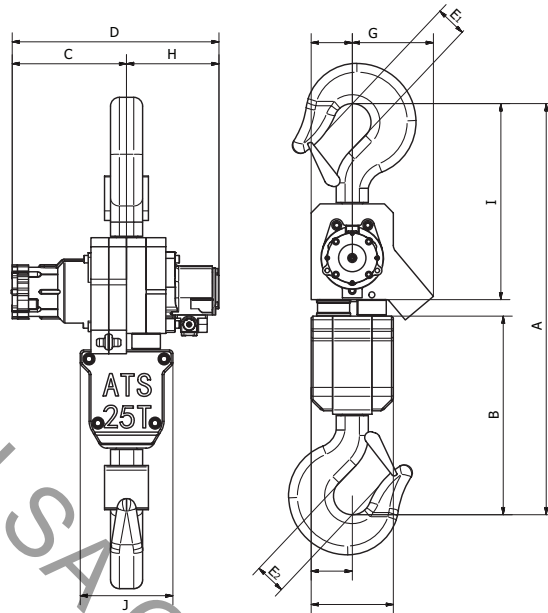

ATS INDUSTRIAL SERIES AIR CHAIN HOIST 15ton-25ton

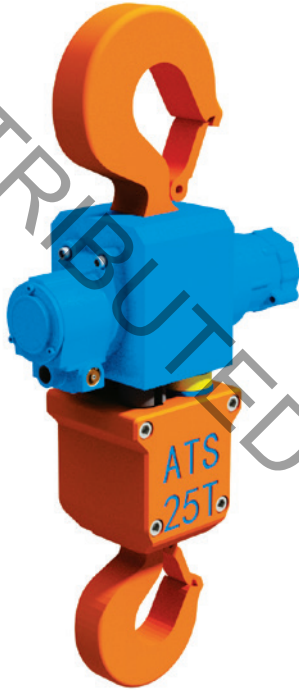

SPECIFICATIONS - ATS AIR CHAIN HOIST - 15ton - 25ton

Lifting Capacity	mt	15	20	25
	T	16.5	22	27.5
Number of Fall of Chain		3	4	4
Motor Power Output	H.P.	3.4	3.4	3.4
	kW	2.5	2.5	2.5
Weight with Pull Cord	lbs.	518	683	794
Weight with Pilot Pendant	lbs.	525	690	801
Chain Weight Per Additional Foot of Lift	lbs.	3.75	6.25	7.5
Chain Dimension	mm	16 x 45	16 x 45	16 x 45
Air Pressure	PSI	87	87	87
	bar	6	6	6
Air Consumption at Full Load	cfm	110	110	110
	m3/min	1.75	1.75	1.75
Air Hose Connection	1" BSP			
Air Hose Dimension	3/4" (19mm - 25mm)			
Lifting Speed at Full Load	ft. / min.	2.9	2.1	1.7
Lifting Speed without Load	ft. / min.	6.1	4.6	4.5
Lower Speed with Full Load	ft. / min.	4.8	5.9	6
Standard Lift	ft.	10	10	10
Length of Control for Standard Lift	ft.	6.5	6.5	6.5
Noise Level	84 DbA @ 1m			

DIM. - ATS AIR CHAIN HOIST - 15ton - 25ton

Type		15	20	25
A min. headroom	inch	37.0	38.5	40.5
	mm	940	979	1028.0
B	inch	17.1	18.0	19.4
	mm	434	457	494.0
C	inch	10.5	10.5	10.5
	mm	267	267	267.0
D	inch	20.5	20.5	20.5
	mm	521	521	521.0
E1	inch	1.9	1.9	2.2
	mm	48	48	56.0
E2	inch	1.9	1.9	2.2
	mm	48	48	56.0
G maximum width	inch	21.3	24.9	27.6
	mm	541	633	700.0
H	inch	10.0	10.0	10.0
	mm	254	254	254.0
I	inch	20.2	18.6	19.4
	mm	514	472	494.0
J (hook Width)	inch	2.5	2.5	2.8
	mm	63	63	71.0

* Chain containers will increase headroom



ATS INDUSTRIAL SERIES AIR CHAIN HOIST 30ton-37ton

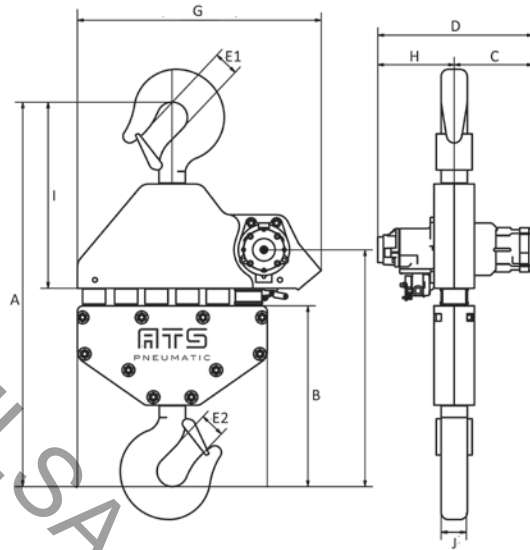
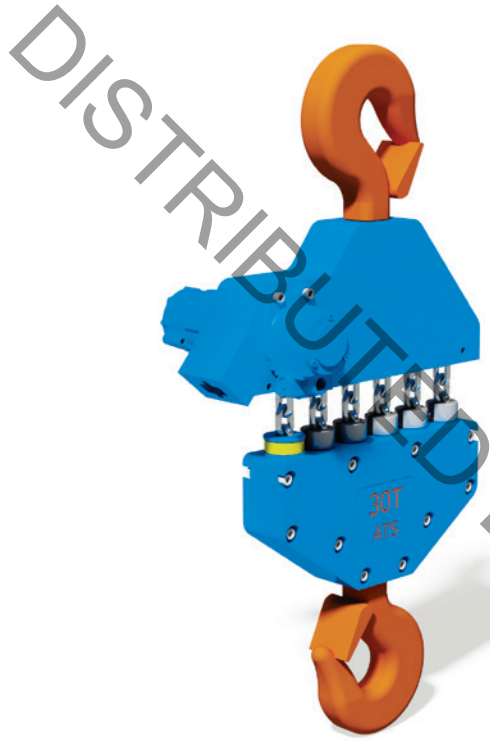

SPECIFICATIONS - ATS AIR CHAIN HOIST - 30ton - 37ton

Lifting Capacity	mt	30	37
	T	33	40
Number of Fall of Chain		6	6
Motor Power Output	H.P.	3.4	3.4
	kW	2.5	2.5
Weight with Pull Cord	lbs.	1350	1350
Weight with Pilot Pendant	lbs.	1360	1360
Chain Weight Per Additional Foot of Lift	lbs.	10	10
Chain Dimension	mm	16 x 45	16 x 45
Air Pressure	PSI	87	87
	bar	6	6
Air Consumption at Full Load	cfm	110	110
	m3/min	1.75	1.75
Air Hose Connection		1" BSP	
Air Hose Dimension		3/4" (19mm - 25mm)	
Lifting Speed at Full Load	ft. / min.	1	1
Lifting Speed without Load	ft. / min.	2	2
Lower Speed with Full Load	ft. / min.	1.5	1.5
Standard Lift	ft.	10	10
Length of Control for Standard Lift	ft.	6.5	6.5
Noise Level		84 DbA @ 1m	

DIM. - ATS AIR CHAIN HOIST - 30ton - 37ton

Type		30	37
A min. headroom	inch	51.8	51.8
	mm	1315.0	1315.0
B	inch	24.4	24.4
	mm	619.5	619.5
C	inch	10.7	10.7
	mm	271.0	271.0
D	inch	20.9	20.9
	mm	532.0	532.0
E1	inch	3.1	3.1
	mm	80.0	80.0
E2	inch	3.1	3.1
	mm	80.0	80.0
G maximum width	inch	32.9	32.9
	mm	835.0	835.0
H	inch	10.3	10.3
	mm	261.0	261.0
I	inch	25.1	25.1
	mm	637.1	637.1
J (hook Width)	inch	3.0	3.0
	mm	75.0	75.0

* Chain containers will increase headroom





ATS INDUSTRIAL SERIES AIR CHAIN HOIST 50ton

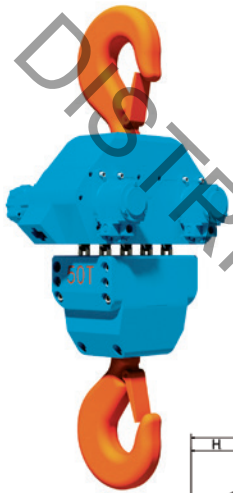

Hook Type

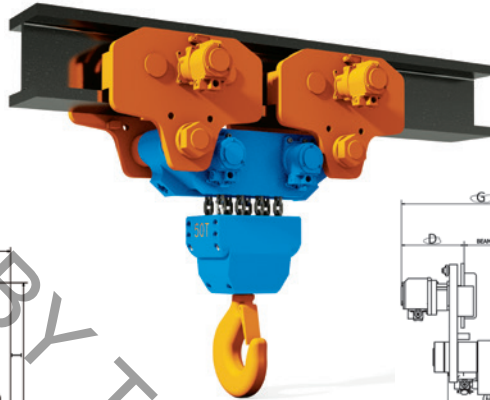
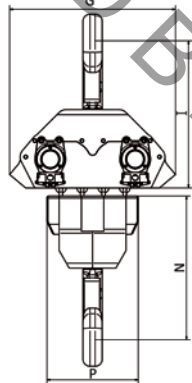
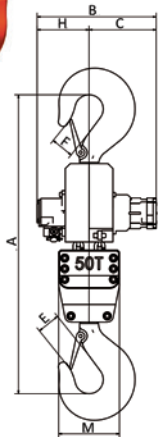

Monorail Type

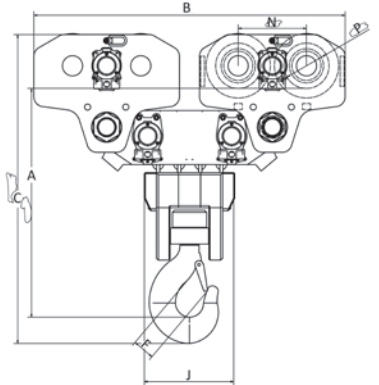
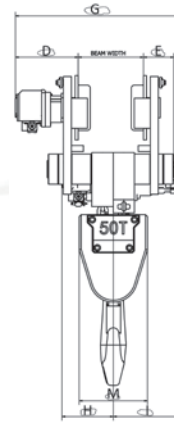

SPECIFICATIONS - ATS AIR CHAIN HOIST - 50ton			
		Hook Mount	Monorail
Lifting Capacity	mt	50	50
	T	55	55
Number of Fall of Chain		8	8
Motor Power Output	H.P.	3.4 x 2	3.4 x 2
	kW	2.5 x 2	2.5 x 2
Weight with Pull Cord	lbs.	2050	2991
Weight with Pilot Pendant	lbs.	2057	2998
Chain Weight Per Additional Foot of Lift	lbs.	15	15
Chain Dimension	mm	16 x 45	16 x 45
Air Pressure	PSI	87	87
	bar	5 to 7	5 to 7
Air Consumption at Full Load	cfm	220	220
	m3/min	6.2	6.2
Air Hose Connection	1.5" BSP		
Air Hose Dimension	1" (19mm - 25mm)		
Lifting Speed at Full Load	ft. / min.	1.8	1.8
Lifting Speed without Load	ft. / min.	3.2	3.2
Lower Speed with Full Load	ft. / min.	4.5	4.5
Traversing speed with Full Load	ft. / min.	NA	39
Standard Lift	ft.	10	10
Length of Control for Standard Lift	ft.	6.4	6.5
Noise Level	84 DbA @ 1m		

DIM. - ATS AIR CHAIN HOIST - 50ton			
Type		Hook	Monorail
A min. headroom	inch	58	44
	mm	1475	1120
B	inch	23	61
	mm	587	1550
C	inch	13	60
	mm	331	1534
D	inch	23	12
	mm	587	313
E	inch	4	6
	mm	100	151
F	inch	4	4
	mm	114	100
G maximum width	inch	32	32
	mm	818	819
H	inch	10	10
	mm	256	256
I	inch	29	13
	mm	727	331
M (Block Width)	inch	12	13
	mm	300	340
N	inch	28	13
	mm	710	340
P	inch	18	9
	mm	450	225

* Chain containers will increase headroom

ELEPHANT
LIFTING PRODUCTS™

CALL TOLL-FREE 888-844-6113